

EK30

HYDRAULIC PILING RIG



GEAX EK30

NO COMPROMISE

HIGH PRODUCTIVITY

Thanks to an efficiently engineered hydraulics with high quality components and a powerful last generation engine, the EK30 offers superior performance relative to the size, while keeping very low running costs.

UNIQUE ARCHITECTURE

Like all Geax machines, the EK30 has a long supporting boom and a sliding mast. This allows a great variety of tool positioning for drilling like: long reach drilling, low headroom and maximized tool height for casing.

MANEUVERABILITY

With its compact architecture and a proverbial stability, the EK30 can drill in any site including slopes, uneven terrains and tight spaces. The higher maneuverability allows fast movements compared to a traditional rig.

VERSATILITY

The EK30 can easily be converted in other drilling modes and customized set-up.

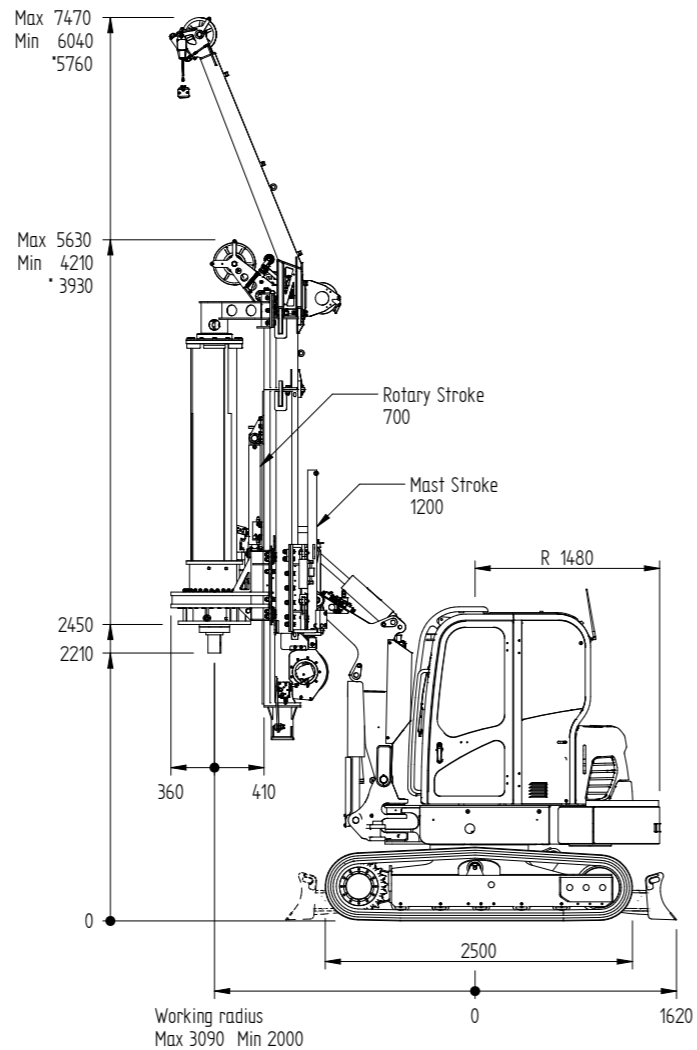

* removing the upper mast extension and with a short kelly bar, max Ø800mm

TECHNICAL DATA SHEET

BASE CARRIER

Engine	type	D24
Exhaust emission	EU EPA	Stage V Tier4f
Engine power	kW (hp)	44.3 (59.4)
Main pumps	l/min	144.9
Hydraulic pressure	bar	275

MAST

Forward tilt	deg	>10
Backward tilt	deg	>10
Lateral tilt	deg	± 6.5
Mast vertical stroke	mm - ft	1.200 - 3.9

WINCHES

Main winch line pull (1st layer)	kN - lbf	40 - 9.000
Aux winch line pull (1st layer)	kN - lbf	17 - 3.800

DRILLING

Max pile diameter ¹	mm - in	800 - 32
Std pile depth	m - ft	16 - 52.5
Max pile depth	m - ft	16 - 52.5
Rotary stroke on mast	mm - ft	700 - 2.3
Total rotary stroke	mm - ft	1.900 - 6.2
Min working headroom ²	mm - ft	3.930 - 12.9

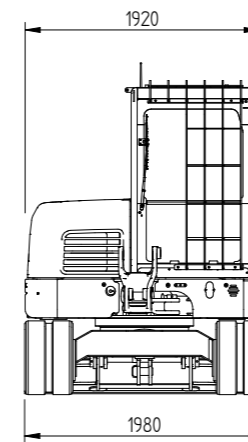

UNDERCARRIAGE

Tracks width	mm - ft	1.980 - 6.5
Tracks length	mm - ft	2.486 - 8.15
Track shoes	mm - ft	400 - 1.31
Tail radius	mm - ft	1.560 - 5.1

ROTARY HEAD

Torque (nominal)	kNm - lbf ft	26 - 19.200
Drilling speed	rpm	10 - 50
Spin-off speed	rpm	50

CROWD SYSTEM

Pull down force	kN - lbf	50 - 11.200
Extraction force	kN - lbf	58 - 13.040

TRANSPORT

Length	mm - ft	6.400 - 21
Width	mm - ft	1.980 - 6.5
Height	mm - ft	2.600 - 8.53
Weight	kg - lbs	9.700 - 21.380

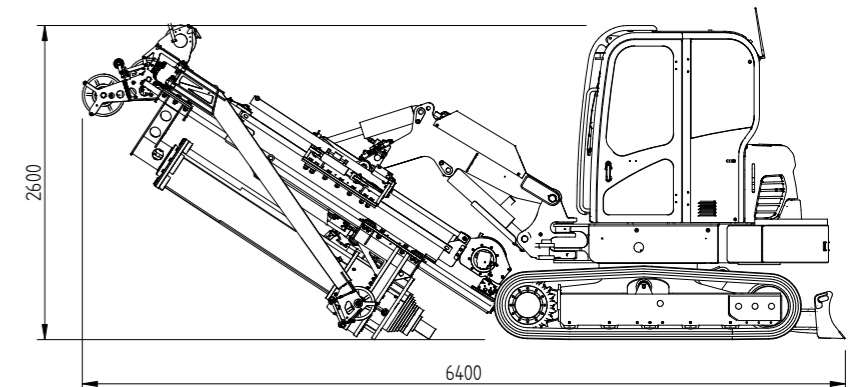

- Values are effective except where otherwise specified.
- Technical data are provided as indicative information only, they are subject to change without prior notice.

NOTES: 1. Recommended
2. Removing the upper mast extension and with a short kelly bar, max Ø800mm



WWW.GEAX.IT
email: info@geax.it
tel: +39 0717131953

GEAX srl
Contrada Passatempo 19
Montefano (MC) ITALY